

## Dual Switching Diode

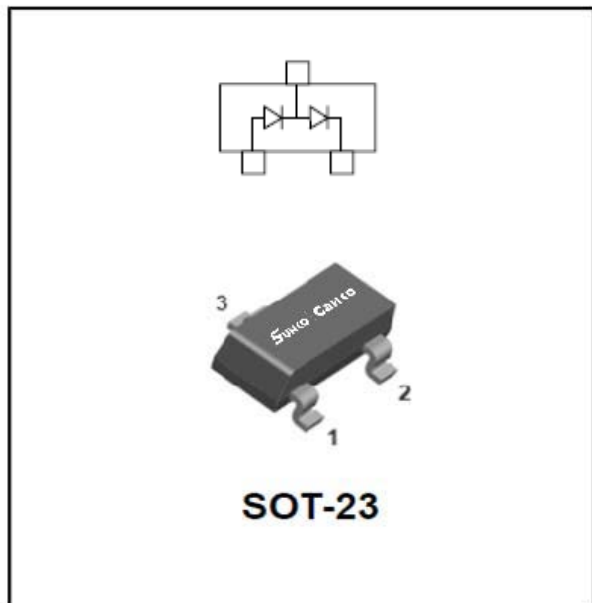

### Features

- Epoxy meets UL-94 V-0 flammability rating
- Moisture Sensitivity Level 1
- Fast switching speed
- High Conductance
- Surface mount package ideally Suited for Automatic Insertion

### Mechanical Data

- **Package:** SOT-23
- **Terminals:** Tin plated leads, solderable per J-STD-002 and JESD22-B102
- **Polarity:** Cathode line denotes the cathode end
- **Marking:** M5C

### ■Maximum Ratings (Ta=25°C Unless otherwise specified)

Item	Symbol	Unit	Value
Peak Reverse Voltage	$V_{RRM}$	V	100
Reverse Voltage	$V_R$	V	100
Forward Continuous Current@f>=50Hz, Per Leg	$I_F$	mA	200
Non-Repetitive Peak Forward Surge Current @tp=1us tp=1s	$I_{FSM}$	A	2 1
Power Dissipation	$P_D$	mW	225
Maximum Thermal Resisance	$R_{thJA}$	°C/W	556
Operating Junction Temperature	$T_J$	°C	-55 to +150
Storage Temperature	$T_{STG}$	°C	-55 to +150

### ■Ordering Information (Example)

PREFERRED P/N	PACKING CODE	UNIT WEIGHT(g)	MINIMUM PACKAGE(pcs)	INNER BOX QUANTITY(pcs)	OUTER CARTON QUANTITY(pcs)	DELIVERY MODE
MMBD7000	F2	Approximate 0.008	3000	30000	120000	7" reel

■ Electrical Characteristics (Ta=25°C Unless otherwise specified, Per Leg)

Item	Symbol	Unit	Conditions	Min	Max
Reverse Voltage	$V_R$	V	$I_R=100\mu A$	100	
Forward Voltage	$V_F$	V	$I_F=1mA$	0.55	0.7
			$I_F=10mA$	0.67	0.82
			$I_F=100mA$	0.75	1.1
Reverse Current	$I_R$	$\mu A$	$V_R=50V$		1
			$V_R=100V$		3
Typical Junction Capacitance	$C_J$	pF	$f=1.0MHz, V_R=0V$		2
Reverse Recovery Time	$T_{rr}$	ns	$I_F=10mA, V_R=6V, R_L=100\Omega, I_{rr}=1mA$		4

■ Typical Characteristics (Per Leg)

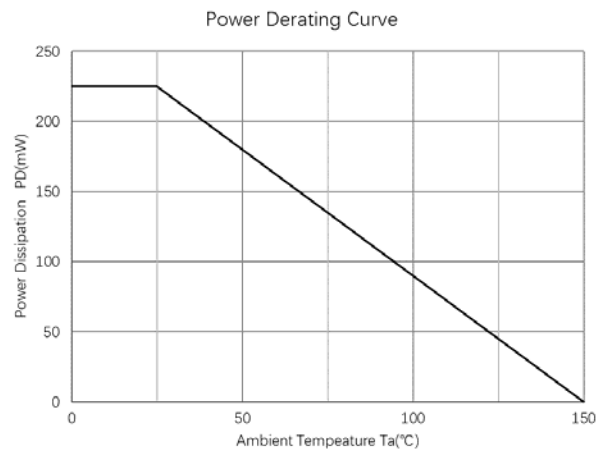
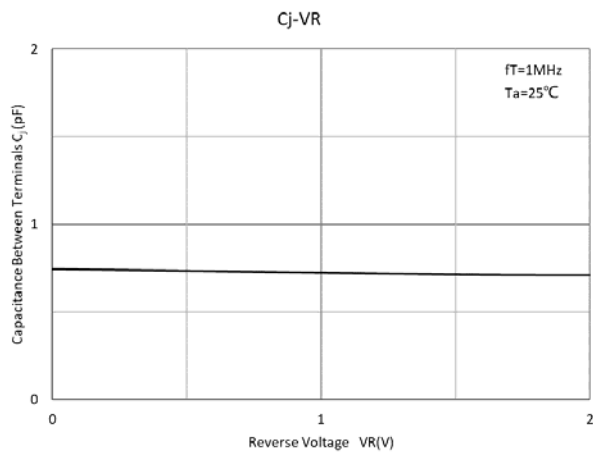
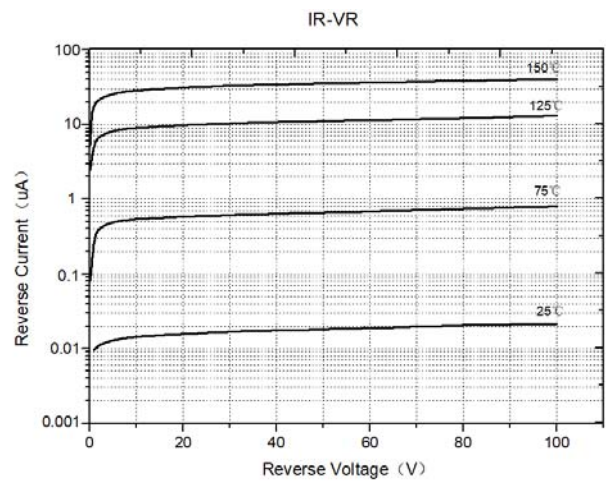
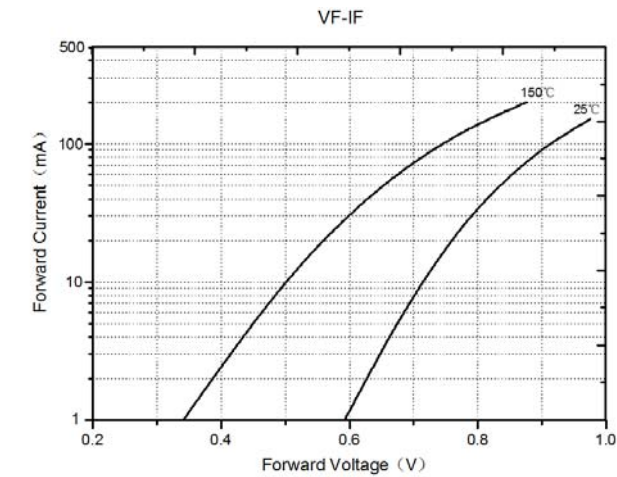

■SOT-23 Package Outline Dimensions

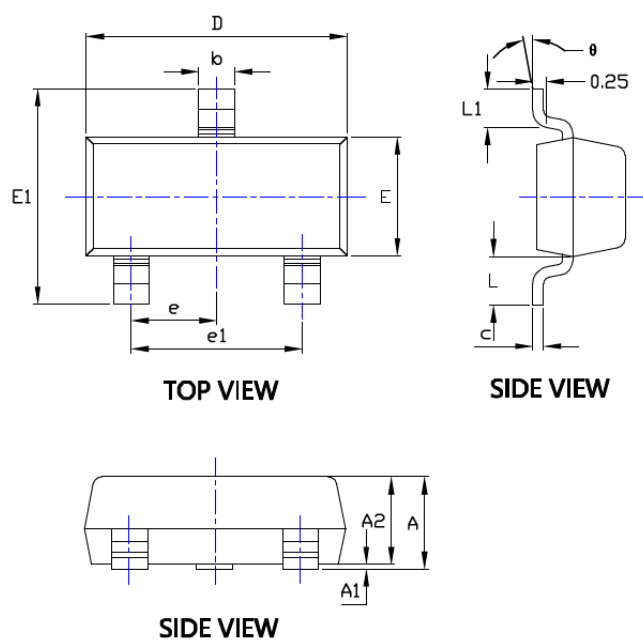

SYMBOL	DIMENSIONS			
	INCHES		Millimeter	
	MIN.	MAX.	MIN.	MAX.
A	0.035	0.045	0.900	1.150
A1	0.000	0.004	0.000	0.100
A2	0.035	0.041	0.900	1.050
b	0.012	0.020	0.300	0.500
c	0.004	0.008	0.100	0.200
D	0.110	0.118	2.800	3.000
E	0.047	0.055	1.200	1.400
E1	0.089	0.100	2.250	2.550
e	0.037TYP		0.950TYP	
e1	0.071	0.079	1.800	2.000
L	0.022REF		0.550REF	
L1	0.012	0.200	0.300	0.500
θ	0°	8°	0°	8°

■SOT-23 Suggested Pad Layout

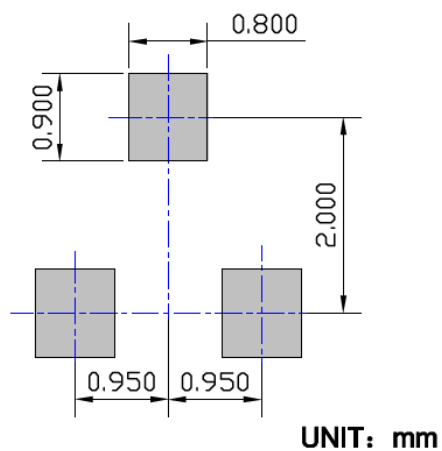

## Disclaimer

The information presented in this document is for reference only. Shanghai Sunco Electronics Co., Ltd reserves the right to make changes without notice for the specification of the products displayed herein to improve reliability, function or design or otherwise.

The product listed herein is designed to be used with ordinary electronic equipment or devices, and not designed to be used with equipment or devices which require high level of reliability and the malfunction of which would directly endanger human life (such as medical instruments, transportation equipment, aerospace machinery, nuclear-reactor controllers, fuel controllers and other safety devices), Russiansunco or anyone on its behalf, assumes no responsibility or liability for any damages resulting from such improper use of sale.

This publication supersedes & replaces all information previously supplied. For additional information, please visit our website [http:// www.russiansunco.com](http://www.russiansunco.com) , or consult your nearest Russiansunco's sales office for further assistance.