

## Schottky Barrier Rectifier

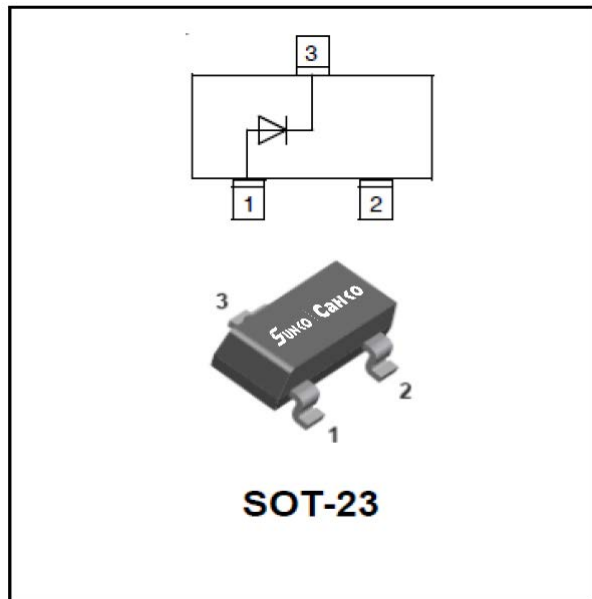

### Features

- VR 40V
- IF 0.1A
- For Surface Mount Application and High Current Capability
- Low Forward Voltage Drop
- Epoxy Meets UL 94 V-0 Flammability Rating
- Moisture Sensitivity Level 1

### Mechanical Data

- **Package:** SOT-23
- **Terminals:** Tin plated leads, solderable per J-STD-002 and JESD22-B102
- **Marking:** A2

### ■Maximum Rating, ( $T_a=25^{\circ}\text{C}$ Unless otherwise specified)

Item	Symbol	Unit	Value
Peak Reverse Voltage	$V_{RRM}$	V	40
Reverse Voltage	$V_R$	V	40
Forward Continuous Current	$I_F$	mA	100
Non-Repetitive Peak Forward Surge Current @8.3ms, Half sine-wave	$I_{FSM}$	A	1
Power Dissipation	$P_D$	mW	200
Thermal Resistance, Junction to Ambient	$R_{thJA}$	$^{\circ}\text{C}/\text{W}$	500
Storage Temperature	$T_{STG}$	$^{\circ}\text{C}$	-55 to +125
Operating Junction Temperature	$T_J$	$^{\circ}\text{C}$	-55 to +125

### ■Ordering Information (Example)

PREFERRED P/N	PACKING CODE	UNIT WEIGHT(g)	MINIMUM PACKAGE(pcs)	INNER BOX QUANTITY(pcs)	OUTER CARTON QUANTITY(pcs)	DELIVERY MODE
RB420DS	F2	Approximate 0.009	3000	30000	120000	7" reel

## ■Electrical Characteristics (T<sub>a</sub>=25°C Unless otherwise specified)

Item	Symbol	Unit	Conditions	MIN	TYP	MAX
Reverse Voltage	V <sub>R</sub>	V	I <sub>R</sub> =100uA	40		
Forward Voltage	V <sub>F</sub>	V	I <sub>F</sub> =1mA		0.28	0.35
			I <sub>F</sub> =10mA		0.36	0.45
			I <sub>F</sub> =100mA			0.6
Reverse Current	I <sub>R</sub>	uA	V <sub>R</sub> =10V			1
			V <sub>R</sub> =40V			5
Diode capacitance	C <sub>j</sub>	pF	V <sub>R</sub> =0V, f <sub>T</sub> =1MHz			25

## ■ Typical Characteristics

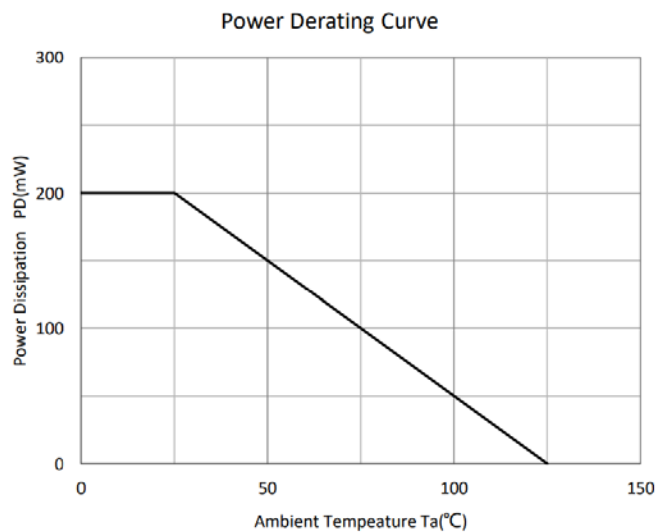
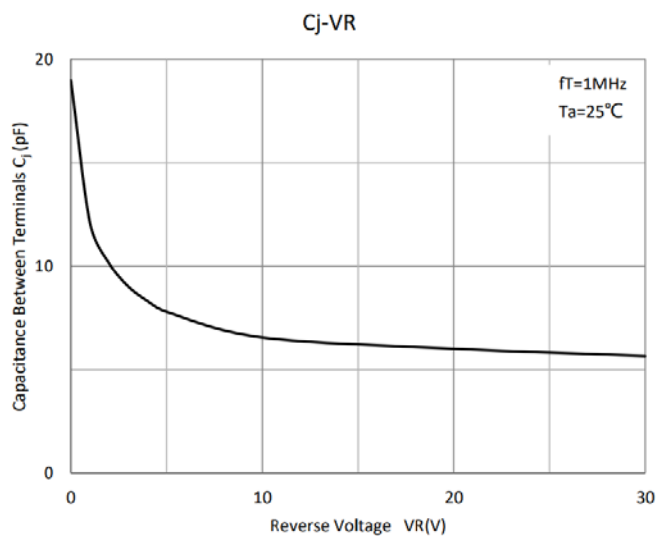
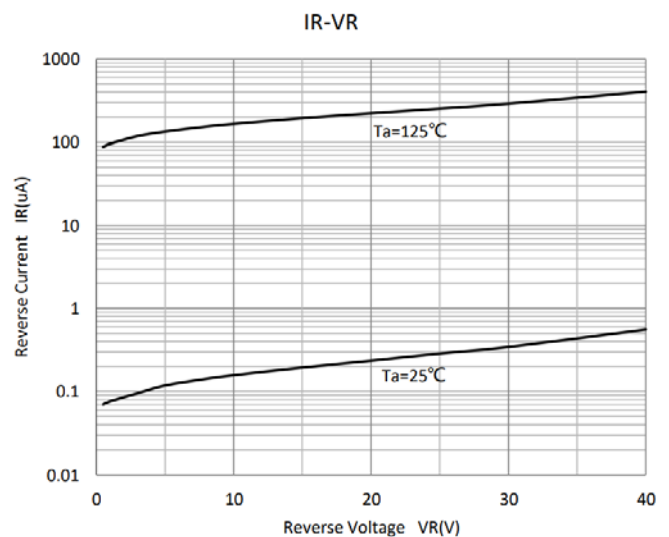
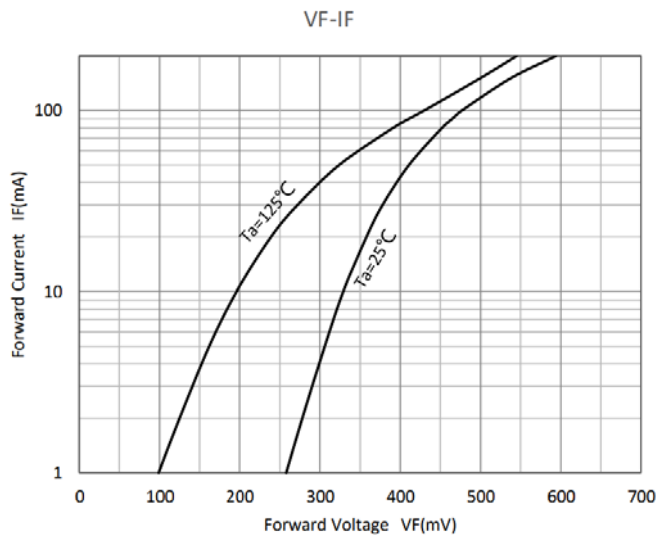

## ■SOT-23 Package Outline Dimensions

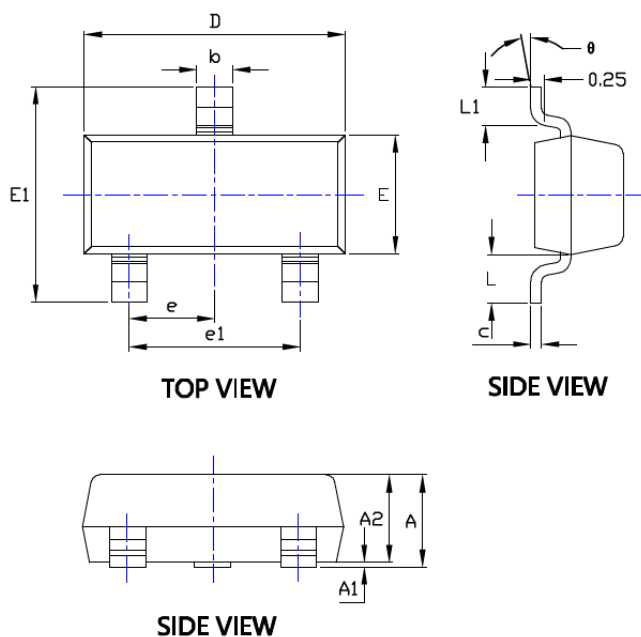

SYMBOL	DIMENSIONS			
	INCHES		Millimeter	
	MIN.	MAX.	MIN.	MAX.
A	0.035	0.045	0.900	1.150
A1	0.000	0.004	0.000	0.100
A2	0.035	0.041	0.900	1.050
b	0.012	0.020	0.300	0.500
c	0.004	0.008	0.100	0.200
D	0.110	0.118	2.800	3.000
E	0.047	0.055	1.200	1.400
E1	0.089	0.100	2.250	2.550
e	0.037TYP		0.950TYP	
e1	0.071	0.079	1.800	2.000
L	0.022REF		0.550REF	
L1	0.012	0.020	0.300	0.500
$\theta$	0°	8°	0°	8°

## ■SOT-23 Suggested Pad Layout

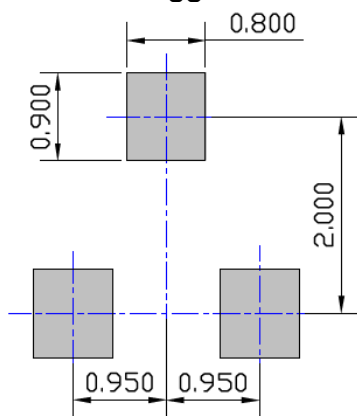

UNIT: mm

## Disclaimer

The information presented in this document is for reference only. Shanghai Sunco Electronics Co., Ltd reserves the right to make changes without notice for the specification of the products displayed herein to improve reliability, function or design or otherwise.

The product listed herein is designed to be used with ordinary electronic equipment or devices, and not designed to be used with equipment or devices which require high level of reliability and the malfunction of which would directly endanger human life (such as medical instruments, transportation equipment, aerospace machinery, nuclear-reactor controllers, fuel controllers and other safety devices), Russiansunco or anyone on its behalf, assumes no responsibility or liability for any damages resulting from such improper use of sale.

This publication supersedes & replaces all information previously supplied. For additional information, please visit our website [http:// www.russiansunco.com](http://www.russiansunco.com) , or consult your nearest Russiansunco's sales office for further assistance.